

4-683.

Mineral Survey No. 3275 A&B

Lot No.

ARIZONA Land District.

FIELD NOTES

OF THE SURVEY OF THE MINING CLAIM OF

C.B.S. MINING COMPANY

KNOWN AS THE

COPPER SILVER GLANCE, INDEX, ORO, ADMIRAL, ORPHAN, OUTSIDER, GENERAL,
ARGENT LODES -Orphan, Index Mill sites

COPPER BASIN Mining District,

YAVAPAI County, ARIZONA

Sections 22, 33 & 34 Unsur., Township 12 & 13 N., Range 3 W. unsurveyed

Surveyed under instructions dated March 7, 1916,

by J. WILLIAM WAARA,
U. S. Deputy Mineral Surveyor

Claim located See location notices, 1

Survey commenced March 9, 1916, 1

Survey completed March 14 1916, 1

Address

o 6-100

Alton M. Cates Atty.

Suite 701 Washington Bldg.

Los Angeles Calif.

MINERAL SURVEY NO. 3275A & B

ADMIRAL LODE.

Beginning at Cor. No.1, a granite stone 9 x 9 x 27 inches long set twelve inches in the ground, with a substantial mound of stone alongside; chiseled A-1-3275A on southeast face, with cross on top for exact corner point, whence,

U.S.M.M. No.1 Copper Basin Mining District, brs. N.20°-53'-45"W. 8702.8 feet.

A granite boulder 3 x 2 x 1.5 feet exposed and chiseled BxR A-1-3275A brs. S.39°-06'W. 34.0 feet.

No other bearings available.

Feet Thence N.66°-28'E.

300.9 NORTH CENTER END, a mound of stone.

302.0 Cross small wash, flows northerly.

601.8 TO COR.NO.2, identical with Cor. No.1 Argent lode of this survey, a granite stone 8 x 10 x 22 inches long set twelve inches in the ground with a substantial mound of stone alongside; chiseled A-2, A-1-3275A, with cross on top for exact corner point, whence,

A rock in place 1 x 1.5 x 1 foot exposed and chiseled BxR A-1-3275A, brs. N.81°-17'E. 37.0 feet.

No other bearings available.

Thence S.28°-10'E.

1500.0 To COR NO. 3, identical with Cor. No.2 Argent Lode, Cor. No.1 General lode and Cor. No.2 Oro lode, all of this survey, a granite stone 10 x 12 x 20 inches long set twelve inches in the ground with a substantial mound of stone alongside; chiseled A-2, G-1-3275A, O-2 and A-3, with cross on top for exact corner point, whence,

A juniper tree 15 inches in diameter and scribed BxT, G-1-3275A, on its east fork, brs. S.30°-36'W. 113.3 ft.

A rock in place 4 x 3 x 2 feet exposed and chiseled BxR, A-2-3275A, brs. N.55°-04'E. 37.3 ft.

Thence S.66°-28'W.

300.9 SOUTH CENTER END, identical with North center End Oro lode of this survey, a mound of stone.

601.8 TO COR. NO.4, identical with Cor. No.1 Oro lode of this survey, a granite stone 5 x 10 x 27 inches long set fifteen inches in the ground with a substantial mound of stone alongside; chiseled O-1, A-4-3275A with cross on top for exact corner point, whence;

A granite rock in place 15 x 8 x 8 feet exposed and chiseled BxR O-1-3275A, brs. S,42°-17'E. 84.0 feet.

No other bearings available.

Thence N.28°-10'W.

1500.0 TO THE PLACE OF BEGINNING. All corners are identical with their respective locations. Variation 14°-30'E.

ARGENT LODE

Beginning at Cor. No.1 identical with Cor. No.2 Admiral lode of this survey, previously described, whence

U.S.M.M.No.1 Copper Basin Mining District, brs. N.24°-51'-35"W. 8695.9 feet.

Thence S.28°-10'E.

1500.0 TO COR. NO. 2, identical with Cor. No. 3 Admiral lode, cor. No.2 Oro lode and Cor. No.1 General lode, all of this survey,

Thence N.66°-28'E.

300.9 SOUTH CENTER END, identical with North Center End General lode of this survey, a mound of stone.

601.8 TO COR. NO. 3, identical with Cor. No. 2 General Lode of this survey, a granite stone 6 x 12 x 24 inches long set twelve inches in the ground with a substantial mound of stone alongside; chiseled A-3,G-2-3275A, with cross on top for exact corner point, whence,

A rock in place 4 x 2 x 1 foot exposed and chiseled BxR G-2-3275A, brs. S.32°-08'W. 24.4 feet.

No other bearings available.

Thence N.28°-10'W.

1500.0 TO COR. NO. 4, a granite stone 8 x 10 x 18 inches long set twelve inches in the ground with a substantial mound

of stone alongside; chiseled A-4-3275A with cross on top for exact corner point,

A rock in place 3 x 2 x 2 feet exposed and chiseled BxR A-4-3275A, brs. S.61°-27'W. 19.8 feet.

No other bearings available.

Thence S.66°-28'W.

100.0 Cross wash flows northerly.
300.9 NORTH CENTER END, a mound of stone.

601.8 TO THE PLACE OF BEGINNING. All corners are identical with their respective locations. Variation 14°-30'E.

ORO LODE.

Beginning at Cor. No. 1, identical with Cor. No. 4 Admiral Lode of this survey, previously described, whence U.S.M.M.No.1 Copper Basin Mining District, brs . N.21°-57'-45"W. 10192.6 feet.

Thence N.66°-28'E.

300.9 NORTH CENTER END, identical with South Center End Admiral lode of this survey, previously described.

601.8 TO COR. NO.2, identical with Cor. No.3 Admiral lode, Cor. No.2 Argent lode and Cor. No. 1 General lode, all of this survey, previously described.

Thence S.18°-59'E.

1500.0 TO COR. NO. 3, identical with Cor. No. 4 General lode, Cor.No.3 Outsider lode, and Cor. No. 4 Index lode, all of this survey, a granite stone 8 x 12 x 27 inches long set twelve inches in the ground with a substantial mound of stone alongside, chiseled O-3, I-4, O-3, G-4-3275A, with cross on top for exact corner point,

No bearings available.

Thence S.66°-28'W.

300.9 SOUTH CENTER END, identical with North Center End, Index Lode of this survey, a mound of stone.

601.8 TO COR. NO. 4, identical with Cor. No.3 Index lode of this survey, a granite stone 6 x 6 x 20 inches long set twelve inches in the ground with a substantial mound of stone alongside; chiseled O-4-3275A, I-3, with cross on top for exact corner point, whence,

A rock in-place, being a granite reef eight feet high, chiseled BxR I-3-3275A, brs. N.64° - 36'E. 57.5 feet. No other bearings available. Variation 13° - 50'E. Thence N.18° - 59'W.

675.0 Cross gulch, flows southwesterly.

1500.0 TO THE PLACE OF BEGINNING. All corners are identical with their respective locations. Variation 14° - 30'E except where otherwise mentioned.

GENERAL LODE.

Beginning at Cor. No.1, identical with Cor. No.2 Oro lode, Cor. No. 3 Admiral Lode, and Cor. No. 2 Argent lode, all of this survey, previously described, whence U.S.M.M.No.1 Copper Basin Mining District, brs. N.25° - 20' - 45"W. 10193.9 feet.

Thence N.66° - 28'E.

300.9 NORTH CENTER END, identical with South Center End Argent lode of this survey, previously described.

601.8 TO COR. NO. 2, identical with Cor. No. 3 Argent Lode of this survey, previously described.

Thence S.18° - 59'E.

1500.0 TO COR. NO. 3, identical with Cor. No.4 Outsider lode of this survey, a granite stone 5 x 10 x 20 inches long set twelve inches in the ground with a substantial mound of stone alongside, chiseled G-3, O-4-3275A, with cross on top for exact corner point, whence,

A granite rock in place 4 x 10 x 5 feet exposed and chiseled BxR G-3, O-4-3275A, brs. N.66° - 28'E. 23.5 ft.

No other bearings available.

Thence S.66° - 28'W.

300.9 SOUTH CENTER END, identical with North Center End, Outsider lode of this survey, a mound of stone.

601.8 TO COR. NO. 4, identical with Cor. No.3 Oro Lode, Cor. No.4 Index and Cor. No.3 Outsider lode, all of this survey, previously described.

Thence N.18°-59'W.

1500.0 TO THE PLACE OF BEGINNING. All corners are identical with their respective locations. Variation 14°-30'E.

INDEX LODE.

Beginning at Cor. No.1, identical with Cor. No.1 Copper Silver Glance lode, Cor. No.4 Orphan Lode and Cor. No. 2 Outsider Lode all of this survey, a granite stone 6 x 9 x 20 inches long set twelve inches in the ground with a substantial mound of stone alongside; chiseled I-1-3275A, O-2, O-4, C-1, with cross on top for exact corner point, whence,

A granite rock in place 4 x 6 x 6 feet exposed and chiseled BxR O-2-3275A, brs. N.42°-32'E. 26.0 feet.
U.S.M.M.No.3275, brs. N.86°-29'E. 1117.3 feet.
No other bearings available, variation 14°-45'E.

Thence S.66°-28'W.

301.0 SOUTH CENTER END, identical with North Center End, Copper Silver Glance Lode of this survey, a mound of stone.

602.0 TO COR. NO. 2, identical with Cor. No. 4 Copper Silver Glance lode of this survey, a granite stone 5 x 10 x 24 inches long set twelve inches in the ground with post in mound of stone alongside; chiseled I-2, C-4-3275A with cross on top for exact corner point, whence,

A granite boulder 6 x 4 x 4 feet high and chiseled BxR I-2-3275A, brs. S.4°-09'W. 6.2 feet.
No other bearings available.

Thence N.18°-42'W.

680.0 Cross gulch, flows westerly.

1499.8 TO COR. NO. 3, identical with Cor. No. 4 Oro lode of this survey, previously described.

Thence N.66°-28'E.

300.9 NORTH CENTER END, identical with South Center End, Oro lode of this survey, previously described.

601.8 TO COR. NO. 4, identical with Cor. No.3 Oro lode, Cor. No.4 General Lode, and Cor. No. 3 Outsider lode all of this survey, previously described.

Thence S.18°-42'-30"E.

1219.9 Cross gulch, flows southwesterly.

1499.9 TO THE PLACE OF BEGINNING. All corners are identical with their respective locations Variation $14^{\circ}-30'E$, except where otherwise mentioned.

OUTSIDER LODE.

Beginning at the point for Corner No.1, identical with Cor. No.1 Orphan lode of this survey, where it was impracticable to set stone for corner due to steep slope, so I established a Witness Corner $S.66^{\circ}-28'W$. 3.9 feet, it being a granite stone 6 x 8 x 27 inches long set fifteen inches in the ground with a substantial mound of stone at the point for corner; chiseled W C-0-1, 3275A, with cross on top for exact corner point, whence

A rock in place 2 x 3 x 1 foot exposed and chiseled BxR O-1-3275A, brs. $N.33^{\circ}-58'E$. 6.9 feet.

A rock in place 2 x 5 x 3 feet exposed and chiseled O-1-3275A, brs. $S.37^{\circ}-23'W$. 9.6 feet.

U.S.M.M. No. 3275, Copper Basin Mining District, brs. $S.73^{\circ}-02'E$. 588.9 feet.

Thence $S.66^{\circ}-28'W$.

301.0 SOUTH CENTER END, identical with North Center End Orphan lode of this survey, a mound of stone.

602.0 TO COR. NO. 2, identical with Cor. No.4 Orphan lode, Cor. No.1 Copper Silver Glance Lode, and Cor. No.1 Index lode all of this survey, previously described.

Thence $N.18^{\circ}-42'-30"W$.

280.0 Cross gulch, flows southwesterly.

1499.9 TO COR. NO.3, identical with Cor. No.4 Index lode, Cor. No.3 Oro lode, and Cor. No.4 General lode, all of this survey, previously described.

Thence $N.66^{\circ}-28'E$.

300.9 NORTH CENTER END, identical with South Center End,

General lode of this survey, previously described.

601.8 TO COR. NO.4, identical with Cor. No. 3 General Lode of this survey, previously described.

Thence $S.18^{\circ}-43'E$.

1500.0 TO THE PLACE OF BEGINNING. All corners are identical with their respective locations. Variation 14°-30'E except where otherwise mentioned.

COPPER SILVER GLANCE LODE.

Beginning at Cor. No.1, identical with Cor. No.1 Index lode, Cor. No.2 Outsider lode and Cor. No.4 Orphan lode, all of this survey, previously described, whence U.S.M.M.No. 3275, Copper Basin Mining District, brs. N.86°-29'E. 1117.3 feet.

Thence S.18°-36'E.

1500.0 TO COR. NO.2, identical with Cor. No.3 Orphan lode of this survey, a granite stone 10 x 12 x 30 inches long, set fifteen inches in the ground with a substantial mound of stone alongside, chiseled O-3, C-2-3275A with cross on top for exact corner point, whence,

A rock in place being a granite reef 3 x 6 x 15 feet long, chiseled BxR O-3-3275A, brs. N.57°-47'E. 20.4 ft.

Variation 14°-50'E.

Thence S.66°-28'W.

301.0 SOUTH CENTER END, a mound of stone.

602.0 TO THE POINT FOR COR. NO.3, which fell in a wash where it was impracticable to set stone for corner, as it was in a water course, so I established a witness corner N.18 - 36'W. 27.1 feet, a rock in place 4 x 3 x 2 feet exposed and chiseled W C-C-3, 3275A, with cross for exact corner point.

From the true corner point, a rock in place 12 x 6 x 2 feet exposed and chiseled BxR C-3, 3275A, brs. N.16°-22'E. 22.9 feet.

No other bearings available.

Thence N.18°-36'W.

27.1 Witness Corner to Cor.No.3, heretofore described.

1090.0 Cross gulch, flows westerly.

1500.0 TO COR. NO.4, identical with Cor. No.2 Index Lode of this survey, previously described.

Thence N.66°-28'E.
301.0 NORTH CENTER END, identical with South Center End, Index Lode of this survey, previously described.

602.0 TO THE PLACE OF BEGINNING. All corners are identical with their respective locations. Variation 14°-30'E. except where otherwise mentioned.

ORPHAN LODE.

Beginning at Cor. No.1, identical with Cor. No.1 Outsider lode of this survey, previously described, whence U.S.M.M.No. 3275, Copper Basin Mining District, brs. S.73°-02'E. 588.9 feet.

Thence S.18°-36'E.

1500.0 TO COR. NO.2, a granite stone 7 x 14 x 20 inches long, set twelve inches in the ground with a substantial mound of stone alongside; chiseled O-2-3275A with cross on top for exact corner point, whence.

A rock in place 5 x 7 x 6 feet exposed and chiseled BxR O-2-3275A, brs. S.72°-49'E. 30.9 feet.

No other bearings available.

Thence S.66°-28'W.

301.0 SOUTH CENTER END, a mound of stone.

602.0 TO COR. NO. 3, identical with Cor. No.2, Copper Silver Glance lode of this survey, previously described.

Thence N.18°-36'W.

1500.0 TO COR. NO.4, identical with Cor. No.1 Copper Silver Glance Cor. No.1 Index and Cor. No.2 Outsider lodes of this survey, previously described.

Thence N.66°-28'E.

301.0 NORTH CENTER END, identical with South Center End Outsider lode of this survey, previously described.

602.0 TO THE PLACE OF BEGINNING. All corners are identical with their respective locations. Variation 14°-30'E.

INDEX MILLSITE

Beginning at Cor. No.1, a granite stone 5 x 12 x 24 inches long set twelve inches in the ground with a substantial mound of stone alongside; chiseled I M S-1-

3275B, with cross on top for exact corner point, whence,
U.S.M.M. No. 3275, Copper Basin Mining District,
brs. N. 89°-18'-30"E. 1939.0 feet.

Cor. No. 2 Index Lode of this survey brs. S., 43°-
35'E. 394.2 feet.

A juniper tree scribed BxT, 1-I M S, 3275B on its
north fork being nine inches in diameter, brs. S. 41°-59'E.
53.3 feet.

No other bearings available. Variation 14°-20'E.

Thence N. 82°-44'W.

505.0 TO COR. NO. 2, a granite stone 6 x 12 x 26 inches long, set
twelve inches in the ground with a substantial mound of
stone alongside; chiseled 2-I M S-3275B, with cross on
top for exact corner point, whence,

The location monument for this corner, a mound of
stone three foot base and two and one half feet high,
brs. N. 82°-44'W. 43.0 feet.

A granite rock in place 5' x 3' x 3 feet exposed and
chiseled BxR 2-I M S-3275B, brs. S. 72°-31'W. 16.4 ft.

No other bearings available.

Thence N. 24°-04'W.

413.1 TO POINT FOR COR. NO. 3, where it was impracticable to set
a stone for corner, as the point fell on edge of water
course, so I established a witness corner N. 82°-42'E.
66.0 feet, a granite rock in place 20 x 30 x 12 inches

exposed, chiseled W C-3-I M S-3275B with cross for exact
corner point, From the true corner point,

A rock in place 8 x 10 x 7 feet exposed and chi-
seled BxR 3-I M S-3275B, brs. S. 14°-10'E. 83.9 feet.

From the true point for corner, the location
monument for this corner, brs. S. 82°-42'W. 189.6 feet.

No other bearings available.

Thence N. 82°-42'E.

31.3 Cross main wash flows westerly.

66.0 Witness corner to Cor. No. 3, heretofore described.

489.3 TO COR. NO. 4, a granite stone 8 x 10 x 26 inches long
set twelve inches in the ground with a substantial mound

of stone alongside; chiseled 4-1 M S-3275B, with cross on top for exact corner point, whence,

A rock in place 2 x 2 x 1 foot exposed and chiseled BxR 4-1 M S-3275B, brs. N.5°-14'W. 34.1 feet.

No other bearings available. Thence S.20°-07'E.

193.0 Cross wash, flows southwesterly.

534.9 TO THE PLACE OF BEGINNING. All corners are identical with respective locations, except where otherwise mentioned. Variation.14°-30'E. except where otherwise mentioned.

ORPHAN MILLSITE.

Beginning at Cor.No.1, a granite boulder 3 x 2 x 1 foot exposed, with a substantial mound of stone alongside; chiseled 1-0 M S-3275B, with cross for exact corner point, whence,

U.S.M.M.No..3275, Copper Basin Mining District, brs. S.67°-17'W. 1629.0 feet.

Cor. No.1 Orphan Lode of this survey, brs. S.77°-29'W. 2116.2 feet.

A granite boulder 5 x 3 x 3 feet exposed and chiseled BxR 1-0 M S-3275B, brs. N.25°-16'E. 12.0 feet.

No other bearings available. Thence N.31°-08'E.

236.0 Cross wash, flows southeasterly.

487.4 TO COR. NO.2, a granite stone 16 x 12 x 4 inches exposed with a substantial mound of stone alongside; chiseled 2-0 M S-3275B, with cross on top for exact corner point, whence,

A granite boulder 6 x 3 x 3 feet exposed and chiseled BxR 2-0 M S-3275B, brs. N.84°-07'E. 20.8 feet.

No other bearings available. Thence S.33°-19'E.

561.4 TO COR. NO.3, a granite reef fifteen feet high and twenty feet long with a mound of stone on top; chiseled 3-0 M S-3275B, with cross for exact corner point,

No bearings available.

Thence S.31° -08'W.

122.0

Cross wash, flows southeasterly.

372.5

TO COR. NO.4, a granite stone 6 x 8'x 22 inches long set twelve inches in the ground, with a substantial mound of stone alongside; chiseled 4 O M S-3275B, with cross on top for exact corner point, whence,

A rock in place being a granite reef five feet high and chiseled BxR 4 O M S-3275B, brs. N.31° -08'E. 79.5 feet.

An oak tree seven inches in diameter and scribed BxT, 4-0 M S-3275B, brs. N.

Thence N.44° -46'W.

522.3 TO THE PLACE OF BEGINNING. All corners are identical with their respective locations. Variation 14° -30'E.

LODE LINES

As near as can be determined from present developments the veins of the several locations embraced in this claim extend as follows from their respective discovery points:

ADMIRAL lode,

N.28° -10'W. 540 feet and S.28° -10'E. 960 feet.

ARGENT lode,

N.28° -10'W. 1250 feet and S.28° -10'E. 250 feet.

ORO lode

N.18° -59'W. 246 feet and S.18° -59'E. 1254 feet.

GENERAL lode

N.18° -59'W. 1190 feet and S.18° -59'E. 310 feet.

INDEX lode

N.18° -42'W. 1400 feet and S.18° -42'E. 999 feet

OUTSIDER lode

N.18° -42'W. 1481.0 feet and S.18° -42'E. 18.9 feet.

COPPER SILVER GLANCE lode

N.18° -36'W. 67 feet and S.18° -36'E. 1433 feet.

ORPHAN lode.

N.18° -36'W. 30 feet and S.18° -36'W. 1440 feet.

AREAS

| | Area | Area |
|--|--------|--------|
| Total area, Admiral Lode - - - - - | 20.655 | Acres. |
| Total area, Argent Lode - - - - - | 20.655 | " |
| Total area, Oro lode - - - - - | 20.657 | " |
| Total area, General Lode - - - - - | 20.657 | " |
| Total area, Index Lode - - - - - | 20.651 | " |
| Total area, Outsider lode - - - - - | 20.653 | " |
| Total area, Copper Silver Glance - - - - - | 20.652 | " |
| Total area, Orphan lode - - - - - | 20.652 | " |
| Total area, Orphan Millsite - - - - - | 4.999 | " |
| Total area, Index Millsite - - - - - | 4.973 | " |

LOCATION

This survey is located upon unsurveyed land in approximately Secs ^{33 &} 34, T.13 N.R.3 W, and sec 22, T.12 1/2 N.R.3 W. of the Gila and Salt River Base and Meridian, within the Prescott National Forest, ^{Copper Basin} Verde Mining District, Yavapai County, State of Arizona.

EXPENDITURE OF FIVE HUNDRED DOLLARS.

I hereby certify that the value of the labor and improvements made upon, or for the benefit of each of the locations embraced in said mining claim by the claimant or its grantors is not less than five hundred dollars, and that said improvements consist of:

ADMIRAL

No.1 Discovery cut, the center of which bears S.28°-10'E. 540 feet from the north center end, 4 x 20 x 8 foot face.

Value \$125.00

To be accredited to this lode is an equal undivided one eighth interest in the workings of improvement

No. 3 Index lode, as set forth under heading "Common Improvements"

Value \$305.00

To be credited to this lode is an equal undivided one eighth interest in the workings of improvement No.2, Index lode, as set forth under heading "Common Improve-

ments".

Value \$270.00

ARGENT

No.1 Discovery cut and trench, the center of cut
brs. N.28°-10'W. 250 feet from the south center end,
4 x 12 x 10 foot face, and trench 3.5 x 4 x 40 feet long.

Value Cut \$100.00
" trench 75.00
lode

To be accredited to this lode is an equal un-
divided one eighth interest in the workings of improvement

No.2 INDEX lode, as set forth under heading "Common
Improvements".

Value \$270.00

To be accredited to this lode is an equal undi-
vided one eighth interest in the workings of improvement

No.3 Index lode as set forth under heading "Common
Improvements".

Value \$305.00

ORO

No.1 Discovery cut and tunnel, the center of cut
brs. S.18°59'E. 246 feet from the north center end, cut
4 x 28 x 12 foot face, and tunnel 4 x 6 x 10 feet long

Value cut \$225.00
tunnel \$100.00

To be accredited to this lode is an equal undi-
vided one eighth interest in the workings of improvement

No.2 Index lode, as set forth under heading "Common
Improvements".

Value \$270.00

To be accredited to this lode is an equal undi-
vided one eighth interest in the workings of improvement

No.3 Index lode as set forth under heading "Common Improve-
ments".

Value \$305.00

GENERAL.

No.1 Discovery cut, the center of which brs.
N.18°-59'W. 310 feet from the south center end, 4 x 20
x 9 foot face.

Value \$150.00

No.2 Shaft, the center of which brs. S.41°-50'E.
665 feet from Cor. No.1, 4 x 3 x 4 feet deep.

Value \$25.00

No.3 Cut, the center of which brs. S.48°-25'E.
485 feet from Cor. No.1 4 x 12 x 7 foot face.

Value \$50.00

To be accredited to this lode is an equal undi-
vided one eighth interest in the workings of improvement
No.2 Index lode, as set forth under heading "Common
Improvements".

Value \$270.00

To be accredited to this lode is an equal undi-
vided one eighth interest in the workings of improvement
No.3 Index lode as set forth under heading "Common
Improvements".

Value \$305.00

INDEX

No.1 Discovery trench, the south end of which
brs. N.18°-42'W. 99.9 feet from the south center end,
trench 4 x 6 x 80 feet long, caved.

Value \$300.00

No.2 cut tunnels and shaft. the mouth of cut,
brs. N.9°-00'E. 600 feet from Cor. No.2 running north-
easterly 4 feet wide, 16 ft. to face of cut 10 feet high, and
mouth of tunnel 4 x 6' running on same course 16 feet to
center of shaft, on incline, same course, 4 x 6 x 165 feet
deep. At right angles to above cut and tunnel, a cut
and tunnel intersects it at the shaft, cut 4 x 12 x 10
foot face and tunnel 4 x 7 x 16 feet long, having a
total length; of cut, 28 feet; of tunnel 32 feet, and
shaft 165 feet.

| | |
|-----------|------------------|
| Value cut | \$100.00 |
| tunnel | 160.00 |
| shaft | 1650. |
| cut | 190.00 |
| tunnel | 160.00 |
| | <u>\$2160.00</u> |

Of the above improvement No.2 is to be accre-
dited to this lode ~~an~~ an equal undivided one eighth in-
terest, asset forth under heading "Common Improvements".

Value \$270.00

No.3 Cut and tunnel, the mouth of cut brs. N.16°-46'W. 724 feet from Cor. No.2, cut 4 feet wide running N.72°-02'E. at 24 feet face of cut 11 feet high, and mouth of tunnel 4 x 6^{ft} running same course, at 73 feet drift brs. S.48° E. 26 feet, at 141 feet a drift brs. S.18° E 40 feet, 181 feet to face, having a total length of cut, 24 feet and tunnel 223 feet

Value cut \$210.00
tunnel 2230.000
\$2440.00

Of the above improvement No.3 is to be accreted to this lode an equal undivided one eighth interest as set forth under heading "Common Improvements".

Value \$305.00

No.4, trench, the center of which brs. N.31°-18'E. 480 feet from Cor. No.2, 4 x 6 x 24 feet long.

Value \$100.00

No.5, cut, the mouth of which brs. N.74°-13'W. 170 feet from Cor. No.1, 4 x 14 x 8 foot face.

Value \$100.00

No.6 shaft, the center of which brs. N.6°-32'W. 166 feet from Cor. No.2, 4 x 6 x 10 feet deep.

Value \$100.00

No.7, cut and tunnel, the mouth of cut brs. N.38°-07'E. 378 feet from Cor. No.2, 4 feet wide running S.39° E. at 27 feet rface of cut 12 feet high and mouth of tunnel 3.5 x 6 feet, running same course, at 113' to sta. 1; thence N.50° E. 6 feet to sta.2; thence S.22° E. 43 feet to sta. 3; thence S.39°W. 48 feet to upraise, inaccessible, having a total length of cut, 27 feet, and tunnel 183 feet.

Value cut \$200.000
tunnel 1830.00
\$2083.00

No.8, shaft the center of which brs. N.59°-07'E. 378 feet from Cor. No.2, 4 x 10 x 10 feet deep

Value \$100.00

No.9, trench, the south end of which brs.
 N.18°-42'W. 35 feet from the south center end, 4 x 6 x
 33 feet long.

Value \$150.00

OUTSIDER.

No.1, discovery shaft, the center of which brs.
 N.18°-42'W. 18.9 feet from the south center end. 4 x 6 x
 10 feet deep/

Value \$100.00

No.2 cut and tunnel, the mouth of cut, brs.

N.29°-37'W. 337 feet from the south center end, cut 5 feet
 wide,
 /running northwesterly 24 feet to 11 foot face, whence

a tunnel 4 x 6^{ft.} runs on same course 18 feet to face, from
 which latter point a drift runs to the right four feet.

also from face of cut runs a tunnel to left 8 feet.,

having a total length of cut 24 feet and tunnel 30 feet.

Value cut \$175.00
 tunnel 300.00

No.3 Shaft, the center of which brs. S.63°-45'

E.1584 feet from Cor. No. 3, 4 x 6 x 10 feet deep.

Value \$100.00

To be accredited to this lode is an equal undi-
 vided one eighth interest in the workings of improvement

No.2 Index lode as set forth under heading "Common
 Improvements"

Value \$270.00

To be accredited to this lode is an equal
 undivided one eighth interest in the workings of improve-
 ment No.3 Index lode as set forth under heading "Common
 Improvements".

Value \$305.00

COPPER SILVER GLANCE.

No.1 Discovery shaft, the center of which brs.
 S.18°-36'E. 67 feet from the north center end. 6 x 7 x
 30 feet deep caved.

Value \$300.00

To be accredited to this lode is an equal

undivided one eighth interest in the workings of improvement No.2 Index lode as set forth under heading "Common Improvements"

Value \$270.00

To be accredited to this lode is an equal undivided one eighth interest in the workings of improvement No.3 Index lode as set forth under heading "Common Improvements".

Value \$305.00

ORPHAN

No.1 discovery shaft, the center of which bears S.18°-36'E. 60 feet from the north center end. 15 x 8 x 60 feet deep caved.

Value \$600.00

No.2 cut and tunnel, the mouth of tunnel bears S.33°-33'E. 32 feet from the north center end, cut 4 x 14 x 8 foot face and tunnel 4 x 6 x 10 feet long

Value cut \$100.00

tunnel \$100.00

No.3, cut the mouth of which bears S.2°-03'E. 404 feet from the north center end, 4 x 12 x 8 foot face.

Value \$100.00

To be accredited to this lode is an equal undivided one eighth interest in the workings of improvement No.2 Index lode as set forth under heading

"Common Improvements".

Value \$270.00

To be accredited to this lode is an equal undivided one eighth interest in the workings of improvement No.3 Index lode as set forth under heading "Common

Improvements"

Value \$305.00

COMMON IMPROVEMENTS

Improvement No.2 Index lode was run and sunk to develop the ground at a greater depth than was possible through tunnels. The bottom of the shaft is about one hundred feet lower than the lowest tunnel

level and by further sinking, drifts, and cross-cuts the shaft can be used as the main working shaft for the group. I consider the workings of this improvement to be a common improvement, and of such character as to redound to the benefit of the lodes of this survey, and I have apportioned the improvement equally to the benefit of the Admiral, Argent, Oro, General, Index, Outsider, Copper Silver Glance, and Orphan lodes.

Total value of improvement No.2 Index lode \$2160.00
 Value of Equal undivided one eighth interest - - - - - \$270.00

Improvement No.3 Index lode was run as a deep level cross cut tunnel to intersect the ledges traversing the lodes of this group. It is about thirty feet lower in elevation than the collar of Improvement No.2 Index lode. This tunnel is located at the lowest favorable point for a tunnel on the group, and will, when extended be about five hundred feet below the surface of the more elevated ground along the easterly side of this

survey. I consider this improvement a common improvement, and of such character as to redound to the benefit of all the lodes of this survey, and have apportioned the improvement equally to the benefit of the Admiral, Argent, Oro, General, Index, Outsider, Copper Silver Glance, and Orphan lodes.

Total value of improvement No.3 Index lode \$2440.00
 Value of Equal undivided one eighth interest - - - - - \$305.00

OTHER IMPROVEMENTS

INDEX LODE

A cabin 11 x 14 feet long, brs. N.63° - 30'W. 260 from Cor. No.1 Index lode.

ORPHAN MILLSITE

A tent house 12 x 14 feet, brs. S.88° -45'W. 235 feet from Cor. No.3

A well 4 x 6 x 10 feet deep brs. S.79° -30'W. 225 feet from Cor. No.3.

ADJOINING CLAIMS

This survey is entirely surrounded by Public Domain, there being no adjoining claims.

INSTRUMENT.

This survey was made with a Lietz Light Mountain transit-theodolite No.13-5929. The courses were deflected from the meridian as determined by the use of the Saegmuller Solar Attachment. The distances were measured with 150 and 500 foot steel tapes.

REPORT

There are no corners of the Public Survey within two miles of this survey, which could be found or identified, after diligent search. so connections were made to U.S. Mineral Monuments.

U.S.Mineral Monument No.1570 is located near the Hassayampa River about two miles ^{due of} west/the Quartz Mountain shown on the Geological Surveys Quadrangle sheets. It is accordingly more than two miles from this survey, so I established U.S.Mineral Monument No. 3275 as per Manual of Instructions.

Any discrepancies found existing between the lodes as surveyed and described in the location notices are due to errors in the location notices.

William Waara
- U.S.MINERAL SURVEYOR -

FIELD NOTES
of
U.S.M.M. 3275
COPPER BASIN MINING DISTRICT
YAVAPAI COUNTY ARIZONA.

LOCATION.

This monument is located on the divide between Hassayampa and Kirkland creek watersheds, about six hundred feet southerly from the point where the wagon road from Prescott, Arizona reaches the summit, and where the trail to the C.B.S. Mining camp begins.

U.S.M.M. 3275 is a malpais rock in place 12 x 12 x 6 inches exposed and chiseled U S M M 3275 with cross on top for exact corner point, whence,

A granite rock in place 4 x 4 x 2 feet exposed and chiseled BxR U S M M 3275, brs. S.52°-30'E. 143.5 ft.

A granite rock in place 2 x 2 x 3 feet exposed and chiseled BxR U S M M 3275, brs. N.21°-24'E. 88.7 ft.

A post in mound of stone six foot base and five feet high, brs. S.87°-20'W. 4.5 feet.

Sugar Loaf rock, brs. N.36°-25'E. about two miles.

The top of Spruce Mountain, on the divide between Groom Creek and Lynx Creek, brs. N.88°-24'E. about nine miles.

The top of a mountain peak, brs. S.22°-18'E about one and one half miles.

The east rim of Antelope peak, brs. S.29°-10'W. about seventeen miles. ✓

The north gable of the Kirkland Railroad Station on the Santa Fe Prescott and Phoenix Railroad, brs. S 70°-25'W. about nine miles. ✓

No other bearings available, Variation 14°-45'E.

Established by

William W. W. W.
U.S. MINERAL SURVEYOR

Mar. 9 -14, 1916.

Sur. 3275 is southerly and westerly from the Sink to Rise camp (Sur. 3296 by Merritt) and U. S. M. 3275 is nearly due south about one mile from said camp which is on Sink to Rise lode.

FINAL OATHS FOR SURVEYS.

LIST OF NAMES.

A list of the names of the individuals employed by J. WILLIAM WAARA

United States ~~Deputy~~ Mineral Surveyor, to assist in running, measuring, and marking the lines, corners, and boundaries described in the foregoing field notes of the survey of the mining claim of C.B.S. MINING COMPANY, known as the Index, Copper Silver Glance, Orphan, Outsider, Oro, General, Argent, Admiral, lodes and Index, Orphan Millsites
~~known as the~~

and showing the respective capacities in which they acted.

E. H. HAYES _____, Chainman.
_____, Chainman.
_____, Axman.
_____, Flagman.

FINAL OATHS OF ASSISTANTS.

~~WE~~ I, E. H. HAYES,

and _____, do solemnly swear that ~~We~~ I assisted J. WILLIAM

WAARA _____, United States ~~Deputy~~ Mineral Surveyor, in marking the corners and surveying the boundaries of the mining claim of C.B.S. MINING COMPANY, known as the Index, Copper Silver Glance, Orphan, Outsider, Oro, General, Argent, Admiral lodes,
~~known as the~~ Index, Orphan Millsites,

represented in the foregoing field notes as having been surveyed by said ~~deputy~~ mineral surveyor and under his direction; and that said survey has been in all respects, to the best of our knowledge and belief, faithfully and correctly executed, and the corner and boundary monuments established according to law and the instructions furnished by the United States Surveyor-General for ARIZONA.

E. H. Hayes _____, Chainman.
_____, Chainman.
_____, Axman.
_____, Flagman.

Subscribed and sworn to by the above-named persons before me this 15 th.

day of March _____, 1916.

E. J. Horne
Notary Public
My Commission expires April 7, 1919

(4-686.)

FINAL OATH OF U. S. ~~DEPUTY~~ MINERAL SURVEYOR

I, J. WILLIAM WAARA, U. S. ~~Deputy~~ Mineral Surveyor, do solemnly swear that, in pursuance of instructions received from the United States Surveyor General for ARIZONA, dated March 7, 1916, I have, in strict conformity to the laws of the United States, the official regulations and instructions thereunder, and the instructions of said Surveyor General, faithfully and correctly executed the survey of the Mining Claim of C.B.S. MINING COMPANY, known as the, Index, Copper Silver Glance, Orphan, Outsider, Oro, general, Argent, ~~known as the~~ Admiral Lodes, Index, Orphan, Millsites, situate in COPPER BASIN Mining District, YAVAPAI County, ARIZONA, in Section 22, T. 12 1/2 N., R. 3 W. ~~unsurveyed~~, and 3-3-7uns, Township No. 13N, Range No. 3 W. ~~unsurveyed~~, and designated as Survey No. 3275 A & B, as represented in the foregoing field notes, which accurately show the boundaries of said mining claim as distinctly marked by monuments on the ground, and described in the attached copy of the location certificate, which was received by me from the Surveyor General with said instructions, and that all the corners of said survey have been established and perpetuated in strict accordance with the law, official regulations and instructions thereunder; and I do further solemnly swear that the foregoing are the true and original field notes of said survey and my report therein, and that the labor expended and improvements made upon said mining claim by claimant or its grantors are as therein fully stated, and that the character, extent, location and itemized value thereof are specified therein with particularity and full detail, and that no portion of said labor or improvements so credited to this claim has been included in the estimate of expenditures upon any other claim.

J. William Waara
U. S. ~~Deputy~~ Mineral Surveyor.

Subscribed and sworn to by the said J. WILLIAM WAARA,
U. S. ~~Deputy~~ Mineral Surveyor, before me _____
_____ this 15 th.
day of March 1916 _____,

E. F. Horne
Notary Public
My Commission expires April 7, 1919

My Commission expires.

24

AMENDED
Notice of Mining Location
LODE CLAIM

TO ALL WHOM IT MAY CONCERN:

This Mining Claim, the name of which is the COPPER SILVER GLANCE
Mining Claim, situate on lands belonging to the United States of America, and in which there are valuable
mineral deposits, was entered upon and located for the purposes of exploration and purchase by
C. B. S. MINING COMPANY, A CORPORATION ORGANIZED UNDER LAWS OF THE
STATE OF ARIZONA

Locator must insert either "a citizen of the United States," or "who has declared his intention to become a citizen of the United States."

the undersigned, on the 14 day of DECEMBER 1915.

The length of this claim is 1500 feet,
and WE claim 1433 feet,
in a SOUTHEASTERLY direction and

67 feet in a NORTHWESTERLY direction from
the center of the discovery shaft, at which this notice is posted, lengthwise of the claim, together with
THREE HUNDRED feet in width of the surface grounds, on each
side of the center of said claim. The general course of the lode deposit and premises is from the
SOUTHEAST to the NORTHWEST

The claim is situated and located in the COPPER BASIN Mining District, in
YAVAPAI County, in the State of Arizona, about 2 1/4 miles
in a SOUTHERLY direction from COMMERCIAL MINING COMPANY'S
PROPERTY

The surface boundaries of the claim are marked upon the ground as follows: Beginning at
A MOUND OF STONE

at a point in a SOUTHEASTERLY direction 1433 feet from
the discovery shaft (at which this notice is posted,) being in the center of the SOUTHERLY
end line of said claim; thence SOUTHWESTERLY 301 feet to a mound of stone
, being the SOUTHWEST corner of said claim;
thence NORTHWESTERLY 1500 feet to a mound of stone, being at the
NORTHWEST corner of said claim; thence NORTHEASTERLY 301 feet
to a mound of stone at the center of the NORTHERLY end of said claim;
thence NORTHEASTERLY 301 feet to a mound of stone, being at the
NORTHEAST corner of said claim; thence SOUTHEASTERLY 1500
feet to a mound of stone at the SOUTHEAST corner of said claim;
thence SOUTHWESTERLY 301 feet to the place of the beginning.

All done under the provisions of Chapter Six, of Title XXXII, of the Revised Statutes of the United
States, and of an Act of the General Assembly of Arizona, entitled "An Act to Revise and Codify the Laws
of the Territory of Arizona," approved March 16, 1901.

This is an Amended Location Notice of the COPPER SILVER GLANCE
Mining Claim, located by WILLIAM H. SMITH
on the 28 th. day of
MARCH 1885, and recorded in Book 21 of Records of Mines, at
page 158, in the office of the County Recorder of the aforesaid County of YAVAPAI
to which reference is hereby made, and this Amended Location Notice is made and posted to correct errors
in the description in the said Original Location Notice.

Dated and posted on the ground this 14 day of DECEMBER 1915

C. B. S. MINING COMPANY

PER M. E. Spaulding
Agent.

25

STATE OF ARIZONA,

ss.

County of

I, County Recorder in and for the County and State aforesaid, do hereby certify that the within instrument was filed for record at o'clock M., on this day of, 191....., and duly recorded in Book No..... of Records of County, Arizona, at pages.....

Witness my hand and official seal the day and year first above written.

..... County Recorder.

AMENDED
Notice of Location
LODE CLAIM

Dated 191.....
Filed and Recorded at request of

M. E. Spaulding.

Feb., 19th., A. D. 1916.

at **2:30-0'clock, P. M.**

Book **86 of Mines.**

Page **563; Records of Yavapai County, Arizona.**

(SEAL.) **L. S. COLWELL,**
County Recorder.

By **JAMES W. COYNE,**
Deputy Recorder.

Printed and for sale by the Prescott Courier

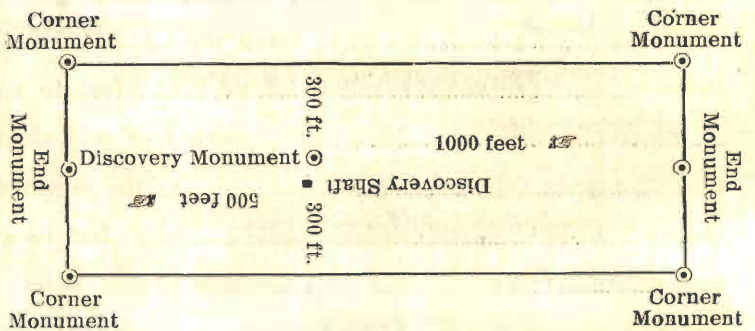

This diagram is to give locator a general idea of plan of location under the new law. The Discovery Shaft can be in the center of claim or any distance from either end desired. In the diagram it is placed 500 feet from one end and 1000 feet from the other. Commence description of claim at a center end monument, giving its distance and direction from center of Discovery Shaft; thence bound the claim in either direction. In description be careful to state locality of claim with reference to some natural object, or permanent monument, as will identify the claim.

2
36

AMENDED
Notice of Mining Location
LODE CLAIM

TO ALL WHOM IT MAY CONCERN:

This Mining Claim, the name of which is the INDEX
Mining Claim, situate on lands belonging to the United States of America, and in which there are valuable mineral deposits, was entered upon and located for the purposes of exploration and purchase by

THE C. B. S. MINING COMPANY. A CORPORATION ORGANIZED UNDER LAWS OF
THE STATE OF ARIZONA

Locator must insert either "a citizen of the United States," or "who has declared his intention to become a citizen of the United States."

the undersigned, on the 14 day of DECEMBER 1915

The length of this claim is 1500 feet,
and WE claim 100 feet,
in a SOUTHEASTERLY direction and

1400 feet in a NORTHWESTERLY direction from
the center of the discovery shaft, at which this notice is posted, lengthwise of the claim, together with
300 feet in width of the surface grounds, on each
side of the center of said claim. The general course of the lode deposit and premises is from the
SOUTHEAST to the NORTHWEST

The claim is situated and located in the COPPER BASIN Mining District, in
YAVAPAI County, in the State of Arizona, about 2 miles
in a SOUTHERLY direction from THE COMMERCIAL MINING
COMPANY'S PROPERTY

The surface boundaries of the claim are marked upon the ground as follows: Beginning at
apost in mound of stone

at a point in a SOUTHEASTERLY direction 100 feet from
the discovery ~~shaft~~ ^{cut} (at which this notice is posted,) being in the center of the SOUTHERLY
end line of said claim; thence SOUTHWESTERLY 301 feet to a mon. of stone
being the S.W. corner of said claim;
thence NORTHWESTERLY 1500 feet to a mon. of stone, being at the
N.W. corner of said claim; thence NORTHEASTERLY 301 feet
to a mon. of stone at the center of the NORTHERLY end of said claim;
thence NORTHEASTERLY 301 feet to a mon. of stone, being at the
N.E. corner of said claim; thence SOUTHEASTERLY 1500
feet to a mon. of stone at the S.E. corner of said claim;
thence SOUTHWESTERLY 301 feet to the place of the beginning.

All done under the provisions of Chapter Six, of Title XXXII, of the Revised Statutes of the United States, and of an Act of the General Assembly of Arizona, entitled "An Act to Revise and Codify the Laws of the Territory of Arizona," approved March 16, 1901.

This is an Amended Location Notice of the INDEX
Mining Claim, located by WILLIAM H. SMITH
on the 28 th. day of
APRIL 1885 ~~18xx~~, and recorded in Book 21 of Records of Mines, at
page 157, in the office of the County Recorder of the aforesaid County of YAVAPAI
to which reference is hereby made, and this Amended Location Notice is made and posted to correct errors in the description in the said Original Location Notice.

Dated and posted on the ground this 14 day of DECEMBER 1915

C. B. S. MINING COMPANY,
per M. Edpaudang AGENT.

County of

ss.

I, County Recorder in and for the County and State aforesaid, do hereby certify that the within instrument was filed for record at o'clock M., on this day of, 191....., and duly recorded in Book No..... of Records of County, Arizona, at pages.....

Witness my hand and official seal the day and year first above written.

County Recorder.

AMENDED
Notice of Location
LODE CLAIM

Dated 191.....
Filed and Recorded at request of
M. F. Spaulding,

Feb., 19th., A. D. 1916.
at 2:30- O'clock, P.M.
Book 86 of Mines;
Page 568; Records of Yavapai
County, Arizona.
(SEAL.) L.S. COLWELL,
County Recorder.

By JAMES W. COYNE,
Deputy Recorder.

Printed and for sale by the Prescott Courier

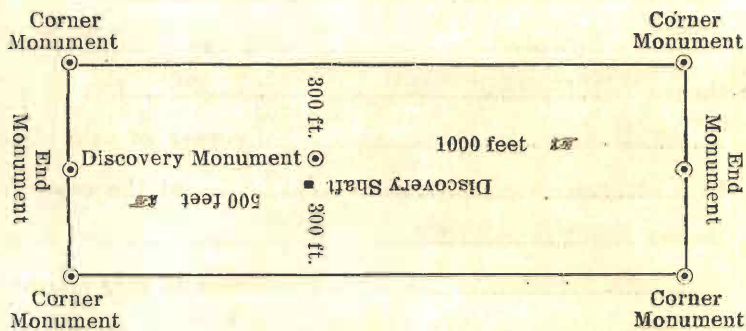

This diagram is to give locator a general idea of plan of location under the new law. The Discovery Shaft can be in the center of claim or any distance from either end desired. In the diagram it is placed 500 feet from one end and 1000 feet from the other. Commence description of claim at a center end monument, giving its distance and direction from center of Discovery Shaft; thence bound the claim in either direction. In description be careful to state locality of claim with reference to some natural object, or permanent monument, as will identify the claim.

3
28

AMENDED
Notice of Mining Location
LODE CLAIM

TO ALL WHOM IT MAY CONCERN:

This Mining Claim, the name of which is the ORO Mining Claim, situate on lands belonging to the United States of America, and in which there are valuable mineral deposits, was entered upon and located for the purposes of exploration and purchase by

C.B.S. MINING COMPANY, A CORPORATION ORGANIZED UNDER LAWS OF THE STATE OF ARIZONA.

Locator must insert either "a citizen of the United States," or "who has declared his intention to become a citizen of the United States."

the undersigned, on the 14 day of DECEMBER 1915.

The length of this claim is 1500 feet, and WE claim 1254 feet, in a SOUTHEASTERLY direction and

246 feet in a NORTHWESTERLY direction from the center of the discovery ^{cut} ~~shaft~~, at which this notice is posted, lengthwise of the claim, together with THREE HUNDRED feet in width of the surface grounds, on each side of the center of said claim. The general course of the lode deposit and premises is from the

SOUTHEAST to the NORTHWEST

The claim is situated and located in the COPPER BASIN Mining District, in YAVAPAI County, in the State of Arizona, about 1 3/4 miles in a SOUTHERLY direction from COMMERCIAL MINING COMPANY'S PROPERTY

The surface boundaries of the claim are marked upon the ground as follows: Beginning at

A MOUND OF STONE

at a point in a SOUTHEASTERLY direction 1254 feet from the discovery ^{cut} ~~shaft~~ (at which this notice is posted,) being in the center of the SOUTHERLY end line of said claim; thence SOUTHWESTERLY 301 feet to a mound of stone, being the SOUTHWEST corner of said claim; thence NORTHWESTERLY 1500 feet to a mound of stone, being at the NORTHWEST corner of said claim; thence NORTHEASTERLY 301 feet to a mound of stone at the center of the NORTHERLY end of said claim; thence NORTHEASTERLY 301 feet to a mound of stone, being at the NORTHEAST corner of said claim; thence SOUTHEASTERLY 1500 feet to a mound of stone at the SOUTHEAST corner of said claim; thence SOUTHWESTERLY 301 feet to the place of the beginning.

All done under the provisions of Chapter Six, of Title XXXII, of the Revised Statutes of the United States, and of an Act of the General Assembly of Arizona, entitled "An Act to Revise and Codify the Laws of the Territory of Arizona," approved March 16, 1901.

This is an Amended Location Notice of the ORO Mining Claim, located by W. H. SMITH

on the 1st. day of OCTOBER 1912, and recorded in Book 92 of Records of Mines, at page 430, in the office of the County Recorder of the aforesaid County of YAVAPAI to which reference is hereby made, and this Amended Location Notice is made and posted to correct errors in the description in the said Original Location Notice.

Dated and posted on the ground this 14 day of DECEMBER 1915

C.B.S. MINING COMPANY

PER M. Espeuldung
Agent

County of

ss.

I, County Recorder in and for the County and State aforesaid, do hereby certify that the within instrument was filed for record ato'clock.....M., on this day of, 191....., and duly recorded in Book No..... ofRecords of County, Arizona, at pages.....

Witness my hand and official seal the day and year first above written.

County Recorder.

AMENDED
Notice of Location
LODE CLAIM

Dated 191.....
Filed and Recorded at request of

M.F. Spaulding,

Feb., 19th., A. D. 1916.

at 2:30- 0'clock, P. M.

Book 86 of Mines:.....

Page 567; Records of Yavapai County, Arizona.

(SEAL.) L.S. COWELL,
County Recorder.

By JAMES W. COYNE,
Deputy Recorder.

Printed and for sale by the Prescott Courier

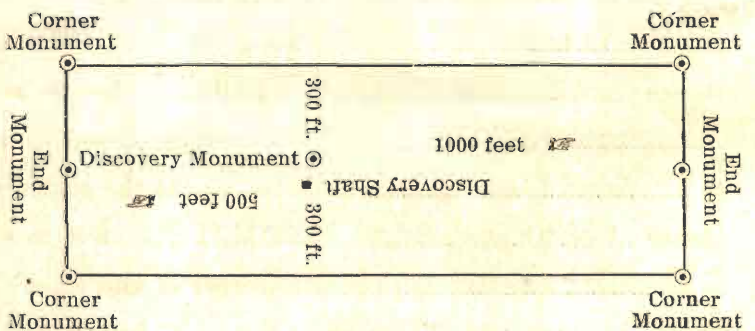

This diagram is to give locator a general idea of plan of location under the new law. The Discovery Shaft can be in the center of claim or any distance from either end desired. In the diagram it is placed 500 feet from one end and 1000 feet from the other. Commence description of claim at a center end monument, giving its distance and direction from center of Discovery Shaft; thence bound the claim in either direction. In description be careful to state locality of claim with reference to some natural object, or permanent monument, as will identify the claim.

4
30

AMENDED
Notice of Mining Location
LODE CLAIM

TO ALL WHOM IT MAY CONCERN:

This Mining Claim, the name of which is the ADMIRAL Mining Claim, situate on lands belonging to the United States of America, and in which there are valuable mineral deposits, was entered upon and located for the purposes of exploration and purchase by

C. B. S. MINING COMPANY, A CORPORATION ORGANIZED UNDER LAWS OF THE STATE OF ARIZONA.

Locator must insert either "a citizen of the United States," or "who has declared his intention to become a citizen of the United States."

the undersigned, on the 14 day of DECEMBER 1915.

The length of this claim is 1500 feet,

and W claim 960 feet,

in a SOUTHEASTERLY direction and 540

feet in a NORTHWESTERLY direction from

the center of the discovery MARK at which this notice is posted, lengthwise of the claim, together with

THREE HUNDRED feet in width of the surface grounds, on each

side of the center of said claim. The general course of the lode deposit and premises is from the

SOUTHEAST to the NORTHWEST

The claim is situated and located in the COPPER BASIN Mining District, in

YAVAPAI County, in the State of Arizona, about 1 1/8 miles

in a SOUTHERLY direction from COMMERCIAL MINING COMPANY'S

PROPERTY

The surface boundaries of the claim are marked upon the ground as follows: Beginning at A MOUND OF STONE

at a point in a SOUTHEASTERLY direction 960 feet from

the discovery cut mark (at which this notice is posted,) being in the center of the SOUTHERLY

end line of said claim; thence SOUTHWESTERLY 301 feet to a mound

of stone, being the SOUTHWEST corner of said claim;

thence NORTHWESTERLY 1500 feet to a mound of stone, being at the

NORTHWEST corner of said claim; thence NORTHEASTERLY 301 feet

to a mound of stone at the center of the NORTHERLY end of said claim;

thence NORTHEASTERLY 301 feet to a mound of stone, being at the

NORTHEAST corner of said claim; thence SOUTHEASTERLY 1500

feet to a mound of stone at the SOUTHEAST corner of said claim;

thence SOUTHWESTERLY 150 301 feet to the place of the beginning.

All done under the provisions of Chapter Six, of Title XXXII, of the Revised Statutes of the United States, and of an Act of the General Assembly of Arizona, entitled "An Act to Revise and Codify the Laws of the Territory of Arizona," approved March 16, 1901.

This is an Amended Location Notice of the ADMIRAL

Mining Claim, located by W. H. SMITH

on the 1 st. day of

OCTOBER 1915 and recorded in Book 92 of Records of Mines, at

page 431, in the office of the County Recorder of the aforesaid County of YAVAPAI

to which reference is hereby made, and this Amended Location Notice is made and posted to correct errors

in the description in the said Original Location Notice.

Dated and posted on the ground this 14 day of DECEMBER 1915

C. B. S. MINING COMPANY

PER M. E. Spaulding
agent

31

County of

I, County Recorder in and for the County and State aforesaid, do hereby certify that the within instrument was filed for record ato'clock.....M., on this day of, 191....., and duly recorded in Book No..... of Records of County, Arizona, at pages.....

Witness my hand and official seal the day and year first above written.

County Recorder.

AMENDED
Notice of Location
LODE CLAIM

Dated 191.....
Filed and Recorded at request of

R.M. Spaulding,

Feb..19th.. A. D. 1916.

at **2:30- 0'clock.** P.M.

Book **86 of Mines:**

Page **562;Records of**

Yavapai County, Arizona.

(SEAL.) **L.S. COLWELL,**
County Recorder.

By **JAMES W. COYNE,**
Deputy Recorder.

Printed and for sale by the Prescott Courier

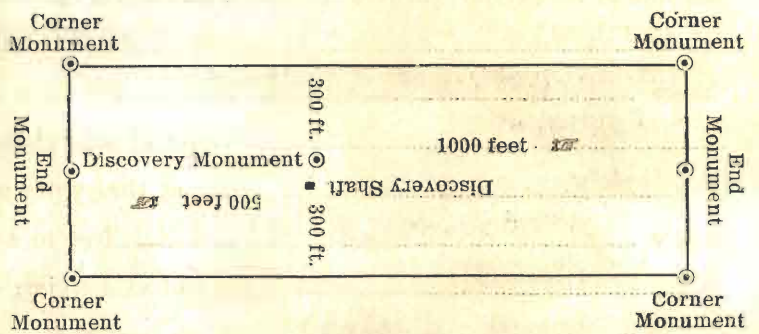

This diagram is to give locator a general idea of plan of location under the new law. The Discovery Shaft can be in the center of claim or any distance from either end desired. In the diagram it is placed 500 feet from one end and 1000 feet from the other. Commence description of claim at a center end monument, giving its distance and direction from center of Discovery Shaft; thence bound the claim in either direction. In description be careful to state locality of claim with reference to some natural object, or permanent monument, as will identify the claim.

5
32

AMENDED
Notice of Mining Location
LODE CLAIM

TO ALL WHOM IT MAY CONCERN:

This Mining Claim, the name of which is the ORPHAN
Mining Claim, situate on lands belonging to the United States of America, and in which there are valuable
mineral deposits, was entered upon and located for the purposes of exploration and purchase by

C.B.S MINING COMPANY, A CORPORATION ORGANIZED UNDER LAWS OF
THE STATE OF ARIZONA

Locator must insert either "a citizen of the United States," or "who has declared his intention to become a citizen of the United States."

the undersigned, on the 14 day of DECEMBER 1915

The length of this claim is 1500 feet,
and WE claim 1440 feet,
in a SOUTHEASTERLY direction and

60 feet in a NORTHWESTERLY direction from
the center of the discovery shaft, at which this notice is posted, lengthwise of the claim, together with
THREE HUNDRED feet in width of the surface grounds, on each
side of the center of said claim. The general course of the lode deposit and premises is from the
SOUTHEAST to the NORTHWEST

The claim is situated and located in the COPPER BASIN Mining District, in
YAVAPAI County, in the State of Arizona, about TWO AND ONE FOURTH MILE
in a SOUTHERLY direction from COMMERCIAL MINING COMPANY'S
PROPERTY

The surface boundaries of the claim are marked upon the ground as follows: Beginning at

A MOUND OF STONE
at a point in a SOUTHEASTERLY direction 1440 feet from
the discovery shaft (at which this notice is posted,) being in the center of the SOUTHERLY
end line of said claim; thence SOUTHWESTERLY 301 feet to a mound of stone
being the SOUTHWEST corner of said claim;
thence NORTHWESTERLY 1500 feet to a mound of stone, being at the
NORTHWEST corner of said claim; thence NORTHEASTERLY 301 feet
to a mound of stone at the center of the NORTHERLY end of said claim;
thence NORTHEASTERLY 301 feet to a mound of stone, being at the
NORTHEAST corner of said claim; thence SOUTHEASTERLY 1500
feet to a mound of stone at the SOUTHEAST corner of said claim;
thence SOUTHWESTERLY 301 feet to the place of the beginning.

All done under the provisions of Chapter Six, of Title XXXII, of the Revised Statutes of the United
States, and of an Act of the General Assembly of Arizona, entitled "An Act to Revise and Codify the Laws
of the Territory of Arizona." approved March 16, 1901.

This is an Amended Location Notice of the ORPHAN
Mining Claim, located by W. H. SMITH

on the 7 th. day of
JANUARY 1893, and recorded in Book 35 of Records of Mines, at
page 427, in the office of the County Recorder of the aforesaid County of YAVAPAI
to which reference is hereby made, and this Amended Location Notice is made and posted to correct errors
in the description in the said Original Location Notice.

Dated and posted on the ground this 14 day of DECEMBER 1915

C.B.S. MINING COMPANY

Per M. Esprauding
Agent

I, County Recorder in and for the County and State aforesaid, do hereby certify that the within instrument was filed for record at o'clock M., on this day of, 191....., and duly recorded in Book No. of Records of County, Arizona, at pages.....

Witness my hand and official seal the day and year first above written.

..... County Recorder.

AMENDED
Notice of Location
LODE CLAIM

Dated 191.....
Filed and Recorded at request of

M.E. Spaulding.

Feb., 19th., A. D. 1916.

at **2:30- O'clock,** P. M.

Book **86 of Mines;**

Page **564; Records of Yavapai County, Arizona.**

(SEAL.) **L.S. COLWELL,**
County Recorder.

By **JAMES W. COYNE,**
Deputy Recorder.

Printed and for sale by the Prescott Courier

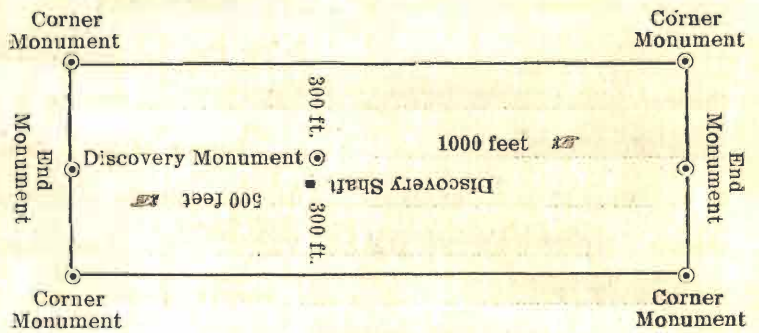

This diagram is to give locator a general idea of plan of location under the new law. The Discovery Shaft can be in the center of claim or any distance from either end desired. In the diagram it is placed 500 feet from one end and 1000 feet from the other. Commence description of claim at a center end monument, giving its distance and direction from center of Discovery Shaft; thence bound the claim in either direction. In description be careful to state locality of claim with reference to some natural object, or permanent monument, as will identify the claim.

6
34

AMENDED
Notice of Mining Location
LODE CLAIM

TO ALL WHOM IT MAY CONCERN:

This Mining Claim, the name of which is the OUTSIDER Mining Claim, situate on lands belonging to the United States of America, and in which there are valuable mineral deposits, was entered upon and located for the purposes of exploration and purchase by C. B. S MINING COMPANY, A CORPORATION ORGANIZED UNDER LAWS OF THE STATE OF ARIZONA

Locator must insert either "a citizen of the United States," or "who has declared his intention to become a citizen of the United States."

the undersigned, on the 14 day of DECEMBER 1915.

The length of this claim is 1500 feet, and WE claim 19.0 feet,

in a SOUTHEASTERLY direction and

1481 feet in a NORTHWESTERLY direction from the center of the discovery shaft, at which this notice is posted, lengthwise of the claim, together with

THREE HUNDRED feet in width of the surface grounds, on each side of the center of said claim. The general course of the lode deposit and premises is from the

SOUTHEAST to the NORTHWEST

The claim is situated and located in the COPPER BASIN Mining District, in YAVAPAI County, in the State of Arizona, about TWO MILES

in a SOUTHERLY direction from COMMERCIAL MINING COMPANY'S PROPERTY

The surface boundaries of the claim are marked upon the ground as follows: Beginning at

A MOUND OF STONE

at a point in a SOUTHEASTERLY direction 19.0 feet from

the discovery shaft (at which this notice is posted,) being in the center of the SOUTHERLY

end line of said claim; thence SOUTHWESTERLY 301 feet to a mound of

stone, being the SOUTHWEST corner of said claim;

thence NORTHWESTERLY 1500 feet to a mound of stone, being at the

NORTHWEST corner of said claim; thence NORTHEASTERLY 301 feet

to a mound of stone at the center of the NORTHERLY end of said claim;

thence NORTHEASTERLY 301 feet to a mound of stone, being at the

NORTHEAST corner of said claim; thence SOUTHEASTERLY 1500

feet to a mound of stone at the SOUTHEAST corner of said claim;

thence SOUTHWESTERLY 301 feet to the place of the beginning.

All done under the provisions of Chapter Six, of Title XXXII, of the Revised Statutes of the United States, and of an Act of the General Assembly of Arizona, entitled "An Act to Revise and Codify the Laws of the Territory of Arizona," approved March 16, 1901.

This is an Amended Location Notice of the OUTSIDER Mining Claim, located by W. H. SMITH

on the 7 day of

JANUARY ~~1893~~ ~~1901~~ and recorded in Book 35 of Records of Mines, at

page 430, in the office of the County Recorder of the aforesaid County of YAVAPAI

to which reference is hereby made, and this Amended Location Notice is made and posted to correct errors

in the description in the said Original Location Notice.

Dated and posted on the ground this 14 day of December 1915.

C. B. S. MINING COMPANY,

Per M. E. Spaulding
Agent.

County of

ss.

I, County Recorder in and for the County and State aforesaid, do hereby certify that the within instrument was filed for record ato'clock.....M, on this day of, 191....., and duly recorded in Book No..... of Records of County, Arizona, at pages.....

Witness my hand and official seal the day and year first above written.

County Recorder.

AMENDED
LODE CLAIM
Notice of Location

Dated 191.....
Filed and Recorded at request of

M. E. Spaulding,

Feb., 19th., A. D. 1916.

at 2:30- O'clock. P. M.

Book 86 Of Mines:

Page 569: Records of Yavapai County, Arizona.

(SEAL.) L. S. COWELL, County Recorder.

By JAMES W. COYNE, Deputy Recorder.

Printed and for sale by the Prescott Courier

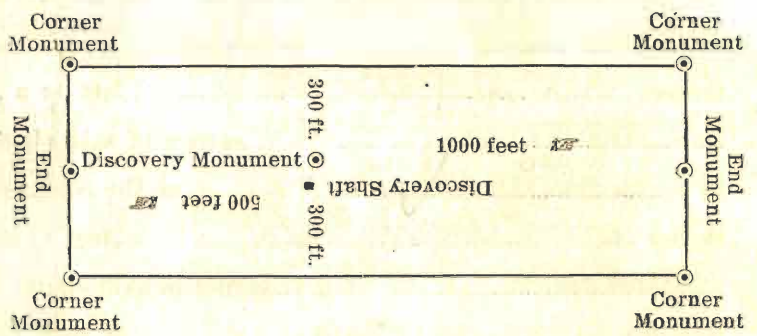

This diagram is to give locator a general idea of plan of location under the new law. The Discovery Shaft can be in the center of claim or any distance from either end desired. In the diagram it is placed 500 feet from one end and 1000 feet from the other. Commence description of claim at a center end monument, giving its distance and direction from center of Discovery Shaft; thence bound the claim in either direction. In description be careful to state locality of claim with reference to some natural object, or permanent monument, as will identify the claim.

7
36

AMENDED
Notice of Mining Location
LODE CLAIM

TO ALL WHOM IT MAY CONCERN:

This Mining Claim, the name of which is the GENERAL
Mining Claim, situate on lands belonging to the United States of America, and in which there are valuable mineral deposits, was entered upon and located for the purposes of exploration and purchase by C.B.S. MINING COMPANY, A CORPORATION ORGANIZED UNDER LAWS OF THE
STATE OF ARIZONA.

Locator must insert either "a citizen of the United States," or "who has declared his intention to become a citizen of the United States."
the undersigned, on the 14 day of DECEMBER 1915

The length of this claim is 1500 feet,
and WT claim 310 feet,
in a SOUTHEASTERLY direction and

1190 feet in a NORTHWESTERLY direction from
the center of the discovery ~~well~~ ^{cut}, at which this notice is posted, lengthwise of the claim, together with
THREE HUNDRED feet in width of the surface grounds, on each
side of the center of said claim. The general course of the lode deposit and premises is from the
SOUTHEAST to the NORTHWEST

The claim is situated and located in the COPPER BASIN Mining District, in
YAVAPAI County, in the State of Arizona, about 1 3/4 miles
in a SOUTHERLY direction from COMMERCIAL MINING COMPANY'S
PROPERTY

The surface boundaries of the claim are marked upon the ground as follows: Beginning at
A MOUND OF STONE

at a point in a SOUTHEASTERLY direction 310 feet from
the discovery ~~well~~ ^{cut} (at which this notice is posted,) being in the center of the SOUTHERLY
end line of said claim; thence SOUTHWESTERLY 301 feet to a mound of
stone, being the SOUTHWEST corner of said claim;
thence NORTHWESTERLY 1500 feet to a mound of stone, being at the
NORTHWEST corner of said claim; thence NORTHEASTERLY 301 feet
to a mound of stone at the center of the NORTHERLY end of said claim;
thence NORTHEASTERLY 301 feet to a mound of stone, being at the
NORTHEAST corner of said claim; thence SOUTHEASTERLY 1500
feet to a mound of stone at the SOUTHEAST corner of said claim;
thence SOUTHWESTERLY 301 feet to the place of the beginning.

All done under the provisions of Chapter Six, of Title XXXII, of the Revised Statutes of the United States, and of an Act of the General Assembly of Arizona, entitled "An Act to Revise and Codify the Laws of the Territory of Arizona." approved March 16, 1901.

This is an Amended Location Notice of the GENERAL
Mining Claim, located by W. H. SMITH
on the 1 st. day of
OCTOBER 1915 and recorded in Book 92 of Records of Mines, at
page 428, in the office of the County Recorder of the aforesaid County of YAVAPAI
to which reference is hereby made, and this Amended Location Notice is made and posted to correct errors
in the description in the said Original Location Notice.

Dated and posted on the ground this 14 day of DECEMBER 191 5

C.B.S. MINING COMPANY

Per M. Esparling
Agent

I, _____, County Recorder in and for the County and State aforesaid, do hereby certify that the within instrument was filed for record at _____ o'clock _____ M., on this _____ day of _____, 191____, and duly recorded in Book No. _____ of _____ Records of _____ County, Arizona, at pages _____

Witness my hand and official seal the day and year first above written.

County Recorder.

AMENDED
Notice of Location
LODE CLAIM

Dated _____ 191____
Filed and Recorded at request of

M.E. Spaulding,

Feb., 19th., A. D. 191 **6.**

at **2:30- 0'clock.** **P.M.**

Book **86 of Mines;**

Page **565; Records of Yavapai County, Arizona.**

(SEAL.) **L.S. COLWELL,**
County Recorder.

By _____ **JAMES W. COYNE,**
Deputy Recorder.

Printed and for sale by the Prescott Courier

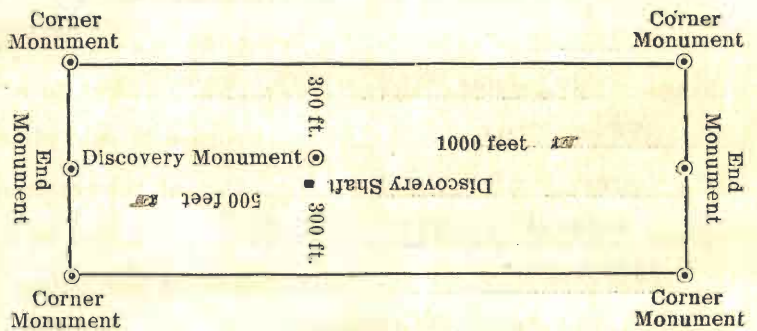

This diagram is to give locator a general idea of plan of location under the new law. The Discovery Shaft can be in the center of claim or any distance from either end desired. In the diagram it is placed 500 feet from one end and 1000 feet from the other. Commence description of claim at a center end monument, giving its distance and direction from center of Discovery Shaft; thence bound the claim in either direction. In description be careful to state locality of claim with reference to some natural object, or permanent monument, as will identify the claim.

4

38

AMENDED
Notice of Mining Location
LODE CLAIM

TO ALL WHOM IT MAY CONCERN:

This Mining Claim, the name of which is the ARGENT
Mining Claim, situate on lands belonging to the United States of America, and in which there are valuable
mineral deposits, was entered upon and located for the purposes of exploration and purchase by
C.B.S. MINING COMPANY, A CORPORATION, ORGANIZED UNDER THE LAWS
OF THE STATE OF ARIZONA.

Locator must insert either "a citizen of the United States," or "who has declared his intention to become a citizen of the United States."

the undersigned, on the 14 day of DECEMBER 1915

The length of this claim is 1500 feet,
and WE claim 250 feet,
in a southeasterly direction and

1350 feet in a NORTHWESTERLY direction from
the center of the discovery ~~mark~~^{cut} at which this notice is posted, lengthwise of the claim, together with
THREE HUNDRED feet in width of the surface grounds, on each
side of the center of said claim. The general course of the lode deposit and premises is from the
SOUTHEAST to the NORTHWEST

The claim is situated and located in the COPPER BASIN Mining District, in
YAVAPAI County, in the State of Arizona, about 1 1/2 miles
in a SOUTHERLY direction from COMMERCIAL MINING COMPANY'S
PROPERTY

The surface boundaries of the claim are marked upon the ground as follows: Beginning at
A MOUND OF STONE

at a point in a SOUTHEASTERLY direction no 250 feet from
the discovery ~~mark~~^{cut} (at which this notice is posted,) being in the center of the SOUTHERLY
end line of said claim; thence SOUTHWESTERLY 301 feet to a mound of
stone, being the SOUTHWEST corner of said claim;
thence NORTHWESTERLY 1500 feet to a mound of stone, being at the
NORTHWEST corner of said claim; thence NORTHEASTERLY 301 feet
to a mound of stone at the center of the NORTHERLY end of said claim;
thence NORTHEASTERLY 301 feet to a mound of stone, being at the
NORTHEAST corner of said claim; thence SOUTHEASTERLY 1500
feet to a mound of stone at the SOUTHEAST corner of said claim;
thence SOUTHWESTERLY 301 feet to the place of the beginning.

All done under the provisions of Chapter Six, of Title XXXII, of the Revised Statutes of the United
States, and of an Act of the General Assembly of Arizona, entitled "An Act to Revise and Codify the Laws
of the Territory of Arizona," approved March 16, 1901.

This is an Amended Location Notice of the ARGENT
Mining Claim, located by W. H. SMITH
on the 1 st. day of
OCTOBER 1912, and recorded in Book 92 of Records of Mines, at
page 429, in the office of the County Recorder of the aforesaid County of YAVAPAI
to which reference is hereby made, and this Amended Location Notice is made and posted to correct errors
in the description in the said Original Location Notice.

Dated and posted on the ground this 14 day of DECEMBER 1915

C.B.S. MINING COMPANY
Per M. Elspalding
Agent

ss.

County of

I, County Recorder in and for the County and State aforesaid, do hereby certify that the within instrument was filed for record ato'clock.....M., on this day of, 191....., and duly recorded in Book No..... of Records of County, Arizona, at pages.....

Witness my hand and official seal the day and year first above written.

..... County Recorder.

AMENDED
Notice of Location
LODGE CLAIM

Dated 191.....
Filed and Recorded at request of

M.E. Spaulding,

Feb., 19th., A. D. 191**6.**

at **2:30 - O'clock,** P. M.

Book **86 of Mines:**

Page **566; Records of Yavapai County, Arizona.**

(SEAL.) **L.S. COLWELL,**
County Recorder.

By **JAMES W. COYNE,**
Deputy Recorder.

Printed and for sale by the Prescott Courier

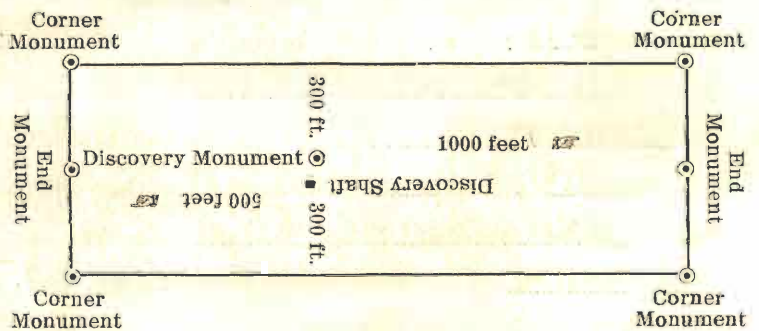

This diagram is to give locator a general idea of plan of location under the new law. The Discovery Shaft can be in the center of claim or any distance from either end desired. In the diagram it is placed 500 feet from one end and 1000 feet from the other. Commence description of claim at a center end monument, giving its distance and direction from center of Discovery Shaft; thence bound the claim in either direction. In description be careful to state locality of claim with reference to some natural object, or permanent monument, as will identify the claim.

Filed and recorded at request of M.E.Spaulding,

February 19th., ----- A. D. 1916, at 2:30 o'clock

P.M., Book 86 of Mines, ----- pages 562-569

Records of Yavapai County, Arizona.

{ SEAL }

L. S. COLWELL,

County Recorder,

By James W. Coyne,

Deputy Recorder.

STATE OF ARIZONA, }
COUNTY OF YAVAPAI. } ss.

I, L. S. Colwell, County Recorder in and for the County of Yavapai, State of Arizona, and custodian of the records of such office, do hereby certify that I have compared the foregoing copies with, and that the same are full, true and correct copies of the following **AMENDED LODE MINING CLAIMS; viz.- Admiral, -Copper Silver Glance, -Orphan, -General, -Argent, -Oro, -Index, -Outsider; - and** filed for record on **Feb, 19th., A.D. 1916, at 2:30-0'clock,** ^{P.M.} and as the same appears of record in my office in Book **86** of **MINES; --** at pages **562-569;** and of the whole thereof.



IN WITNESS WHEREOF, I have hereunto set my hand and affixed my Official Seal this 19th., day of FEBRUARY, A. D. 1916.

L. S. Colwell
County Recorder.

Location Notice

OF

The ORPHAN

Mill-Site Claim and Water Right.

KNOW ALL MEN BY THESE PRESENTS, That WE the undersigned, have this day located a Mill-Site for the purpose of erecting suitable works for reducing the ores of the ORPHAN Mining Claim, situated in COPPER BASIN Mining district, YAVAPAI County, State of Arizona Territory. The exterior boundaries of said ORPHAN Mill-Site Claim are as follows, viz.:

Commencing at a monument of stone at N. E. corner of claim, and running thence in a westerly direction, 466½ feet to mounment of stone at N. W. corner of claim, thence in a southerly direction, 466½ feet to monument of stone at S. W. corner of claim, thence in an easterly direction, 466½ feet to monument of stone at S. E. corner of claim, thence in a northerly direction, 466½ feet to monument of stone at N. E. corner of claim and place of beginning.

This location may be more generally described as being situated about one mile in an easterly direction from the Orphan mining Claim, and three miles southeasterly from Commercial Mining Company's property.

That we have also located in connection with the said Mill-Site claim all water and flood waters ^{surface} of wash passing through ~~in~~ said millsite under and in accordance with the laws of the State Territory of Arizona, regulating the location and possession of water rights

The dimensions of the ditch for diverting the water from its natural course at the head, being as follows: XXXX wide at top, XXXXX wide at bottom, XXXXX in depth, with a uniform grade of XXXXX to the rod.

Dated on the ground, this 26 day of February, 1916.

Witness:

C. B. S. MINING COMPANY

Per M. E. Spaulding Agent

County of } ss.

I,, County Recorder in and for the County and
State of
~~Territory~~ aforesaid, do hereby certify that the within instrument was filed for record at o'clockM.,
on this day of, 191....., and duly recorded in Book No.
of Records of County, Arizona, at pages

Witness my hand and official seal the day and year first above written.

.....
County Recorder.

Location Notice

OF

Mill-Site Claim and Water Right.

Dated, 191.....

Filed and recorded at request of

M.E. Spaulding,

February 26th., A. D. 1916.

at **2:00 O'clock** P. M.

Book **4 Mill Sites & Water Rights;**

Page **310; Records of Yavapai**

County, Arizona.

(**SEAL.**) **L.S. Colwell,**

County Recorder.

By **E.A. McSwiggan,**

Deputy Recorder.

Location Notice

OF

The INDEX
Mill-Site Claim and Water Right.

KNOW ALL MEN BY THESE PRESENTS, That WE the undersigned,
have this day located a Mill-Site for the purpose of erecting suitable works for reducing the ores of the
INDEX Mining Claim,
situated in COPPER BASIN Mining
district, YAVAPAI County, State of, Arizona
Territory. The exterior boundaries of said INDEX
Mill-Site Claim are as follows, viz.:

Commencing at a monument of stone at N. E. corner of claim, and running thence in a westerly
direction, 466½ feet to mounment of stone at N. W. corner of claim, thence in a southerly direction,
466½ feet to monument of stone at S. W. corner of claim, thence in an easterly direction, 466½ feet to
monument of stone at S. E. corner of claim, thence in a northerly direction, 466½ feet to monument of
stone at N. E. corner of claim and place of beginning.

This location may be more generally described as being situated ~~xxx~~ 1/4 miles
in a westerly direction from the INDEX Mining Claim
and about two and one fourth miles in a southerly direction
from the Commercial Mining Company's Property

That we have also located in connection with the said Mill-Site claim all surface and
flood waters of wash passing through
xxx said mill site under and in accordance with the laws of the
State
Territory of Arizona, regulating the location and possession of water rights

The dimensions of the ditch for diverting the water from its natural course at the head, being as
follows: xxx wide at top, xxxxxx wide at
bottom, xxxx in depth, with a uniform grade of xxxxx
to the rod.

Dated on the ground, this 26 day of February, 1916.

Witness:

C. B. S. MINING COMPANY
Per M. E. Spaulding Agent

STATE
~~TERRITORY~~ OF ARIZONA,

County of } ss.

I,, County Recorder in and for the County and
~~Territory~~ State of aforesaid, do hereby certify that the within instrument was filed for record at o'clock M.,
on this day of, 191....., and duly recorded in Book No.
of Records of County, Arizona, at pages

Witness my hand and official seal the day and year first above written.

.....
County Recorder.

Location Notice

OF

Mill-Site Claim and Water Right.

Dated, 191.....

Filed and recorded at request of

M.E. Spaulding.

February 26th., A. D. 1916.

at 2:00 O'clock, P. M.

Book 4 Mill Sites & Water Rights;

Page 311; Records of Yavapai
County, Arizona.

(SEAL.) L.S. Colwell,

County Recorder.

By **E.A. McSwiggan.**
Deputy Recorder.

The McNeil Co., Printers, Phoenix

Filed and recorded at request of M.E.SPAULDING,

February 26th., A. D. 1916, at 2:00 o'clock

P.M., Book 4, - MILL SITES & WATER RIGHTS; ~~####~~ Pages 310-311.

Records of Yavapai County, Arizona.

{ SEAL }

L. S. COLWELL,
County Recorder,

By E.A.MCSWIGGIN.
Deputy Recorder.

STATE OF ARIZONA, }
COUNTY OF YAVAPAI. } ss.

I, L. S. Colwell, County Recorder in and for the County of Yavapai, State of Arizona, and custodian of the records of such office, do hereby certify that I have compared the foregoing copies with, and that the same is a full, true and correct copies of LOCATION NOTICES OF MILL-SITES and WATER RIGHTS; Located by C.B.S. Mining Company, Per., M.E. Spaulding, -Agent, on the 26th., day of February, A.D., 1916, -and P.M., filed for record on Feb., 26th., A.D., 1916; at 2:00-0'clock/ and as the same appears of record in my office in Book 4, of MILL-SITES and WATER RIGHTS; at pages 310-311; and of the whole thereof.



IN WITNESS WHEREOF, I have hereunto set my hand and affixed my Official Seal this 26th., day of FEBRUARY, A. D. 1916.

L.S. Colwell
County Recorder.

U. S. SURVEYOR-GENERAL'S FINAL CERTIFICATE ON FIELD NOTES.

Department of the Interior,

OFFICE OF U. S. SURVEYOR-GENERAL,

Phoenix, Arizona,

September 21, 1916.

I, U. S. Surveyor-General for District of Arizona

do hereby certify that the foregoing transcript of the Field Notes, return and approval of the survey of the mining claim of

C. B. S. MINING COMPANY

known as the COPPER SILVER GLANCE, INDEX, ORO, ADMIRAL, ORPHAN, OUTSIDER, GENERAL, ARGENT Lodes, ORPHAN, INDEX Mill Sites situate in COPPER BASIN

Mining District, YAVAPAI County, ARIZONA.

in Section 22, Township No. 12 $\frac{1}{2}$ N., Range No. 3 W. UNSUR, and Secs. 33 & 34, uns. " " 13 N., " " 3 W. designated as Survey No. 3275 A&B, has been correctly copied from the originals on file inthis office; that said Field Notes furnish such an accurate description of said mining claim as will, if incorporated into a patent, serve fully to identify the premises, and that such reference is made therein to natural objects or permanent monuments as will perpetuate and fix the *locus* thereof.

And I further certify that five hundred dollars' worth of labor has been expended or improvements made upon said mining claim by claimant or its grantors, and that said improvements consist of 13 cuts, 8 shafts, 8 tunnels, 4 trenches, 3 drifts and 1 upraise, total value \$10,258.

Improvements Nos. 2 and 3 on the Index lode being common improvements for the benefit and development of all of the claims in this survey, an undivided one-eighth interest in each of said improvements, value \$270 and \$305, respectively, is properly credited to each of the claims in this survey.

and that no portion of said labor or improvements has been included in the estimate of expenditures upon any other claim.

I further certify that the plat thereof, filed in the U. S. Land Office at Phoenix,

Arizona, is correct and in conformity with the foregoing Field Notes.

Frank P. Trott,

United States Surveyor-General for Arizona.

SURVEYOR-GENERAL'S CERTIFICATE OF APPROVAL OF FIELD NOTES AND SURVEY OF MINING CLAIM.

Department of the Interior,

OFFICE OF U. S. SURVEYOR-GENERAL,

Phoenix, Arizona.

September 21, 1916

I, U. S. Surveyor-General for District of Arizona

do hereby certify that the foregoing and hereto attached Field Notes and Return of the Survey of the Mining Claim of

C. B. S. MINING COMPANY

known as the COPPER SILVER GLANCE, INDEX, ORO, ADMIRAL, ORPHAN, OUTSIDER, GENERAL, ARGENT Lodes, ORPHAN, INDEX Mill Sites.

situate in COPPER BASIN mining district,

YAVAPAI County, ARIZONA.

in Section 22, Township No. 12 1/2 N., Range No. 3 W. unshr. Secs. 33 & 34, unsh. " " 13 N., " " 3 W. designated as Survey No. 3275 A&B

executed by J. William Waara, U. S. Deputy Mineral

Surveyor, March 9-14, 1916 under my instructions dated

March 7, 1916, have been critically examined and the necessary cor-

rections and explanations made, and the said Field Notes and Return, and the Survey they describe,

are hereby approved. A true copy of the copy of the location certificate filed by the applicant for

survey is included in the field notes.

Handwritten signature of Frank P. Bennett

U. S. Surveyor-General for Arizona.

UNITED STATES DEPARTMENT OF THE INTERIOR 9605 (956)
BUREAU OF LAND MANAGEMENT M.S. 3275 A&B
ARIZONA STATE OFFICE

NOTICE OF CANCELLATION OF MINERAL SURVEY

The ORO, ADMIRAL, GENERAL, and ARGENT lodes, ORPHAN and INDEX mill sites, Mineral Survey No. 3275 A&B, located in sections 28, 33 and 34, Township 13 North, Range 3 West, Gila and Salt River Meridian, Arizona, are hereby canceled.

These claims have not been filed with the Arizona State Office, Bureau of Land Management, in accordance with Section 314, 90 STAT. 2769, (43 U.S.C. 1744).

This cancellation was necessitated to clear the record.

The Mineral Survey Plat should be noted as follows:

"ORO, ADMIRAL, GENERAL, and ARGENT lodes, ORPHAN and INDEX mill sites, M.S. 3275 A&B, were canceled March 3, 2011, by memo 9605 (956) M.S. 3275 A&B, which is now a part of the original field notes."

March 3, 2011
Date

Stephan K. Hannon
Chief Cadastral Surveyor of Arizona